

**HSF RoHS**

**SPECIFICATIONS**

Rated Current:3.0AMP  
 Contact Resistance:20mΩ Max  
 Withstand Voltage:1000V AC/DC  
 Insulation Resistance:1000MΩ Min  
 Operation Temperature:-40°C to +105°C

Contact Material:Phosphor bronze  
 Contact Plating:Au or Sn Over Ni  
 Insulator Material:Polyester(UL94V-0)  
 Resistance To Soldering Heat:  
 260°C±5°C, 10s(PA9T insulator)

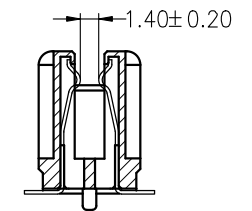
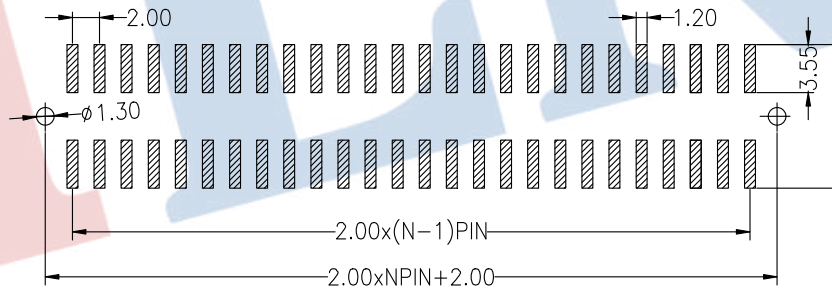
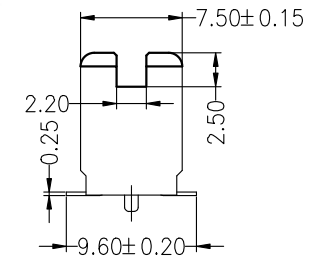
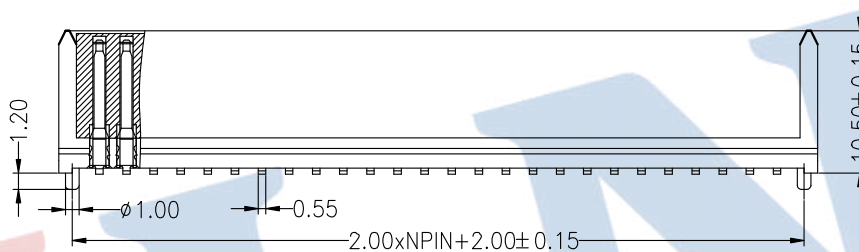
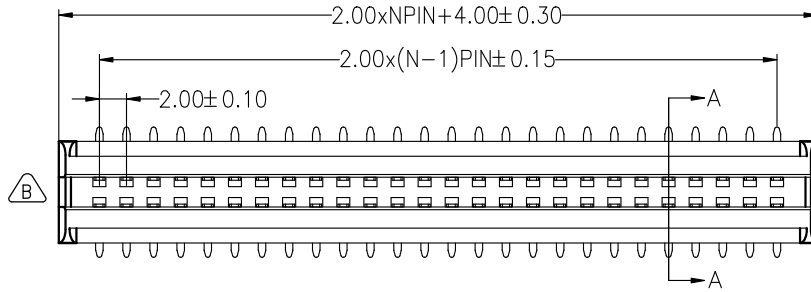

A-A SECTION

Recommended P.C.B Layout

**Ordering Information**

**4410-2 XX M XX F E B W 0X**

No.of Pins  
 2X13P  
 2X15P  
 2X16P  
 2X20P  
 2X23P  
 2X27P  
 2X32P

Contact Plating  
 G0:Gold Flash  
 G1:1U" Gold  
 G2:2U" Gold  
 G3:3U" Gold  
 G4:5U" Gold  
 G5:10U" Gold

OPERATION

|       |       |
|-------|-------|
| X.X   | ±0.30 |
| X.XX  | ±0.20 |
| X.XXX | ±0.10 |
| Angle | ±3°   |
| DIM   | TOL   |

DRAW

CHECK  
 APPROVE

RICH LIN

23.03.07

SCALE

UNIT  
 SIZE  
 SHEET  
 PROJ.

FIT

mm  
 A4  
 1/1

**JILN**® 深圳市锦凌电子有限公司  
 SHENZHEN JINLING ELECTRONICS CO.,LTD

Tel: 86-755-27483253 Fax: 86-755-2997-5588

PART NO.

4410-2XXMXXFEBW0X

TITLE:

2.0加强型金手指连接器 母座 2xNpin H10.5 SMT 带柱

| REV | DATE       | MODIFICATION DESCRIPTION | CHANGE |
|-----|------------|--------------------------|--------|
| B   | 2020.03.20 | 两边加缺口                    |        |
| A   | 2023.03.07 | NEW DRAWING              |        |