

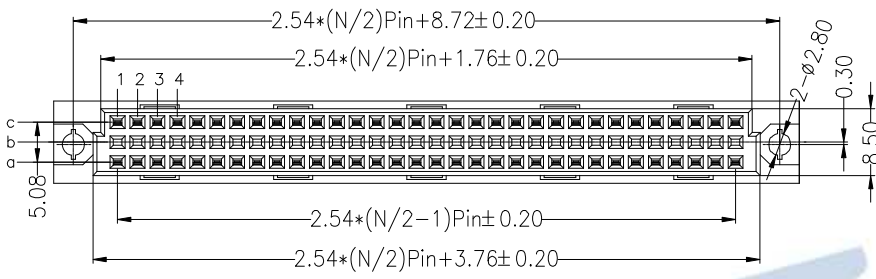

SPECIFICATIONS

Rated Current:3.0AMP
 Contact Resistance:30mΩ Max
 Withstand Voltage:1000V AC/DC
 Insulation Resistance:1000MΩ Min
 Operation Temperature:-40°c to +105°c

Contact Material:Copper Alloy
 Contact Plating:Au or Sn Over Ni
 Insulator Material:Polyester(UL94V-0)
 Resistance To Soldering Heat:
 245° C±5° C For 10 Second(PBT insulator)

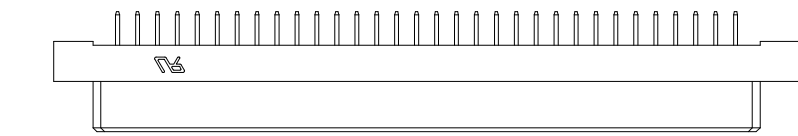

注: 缺b排

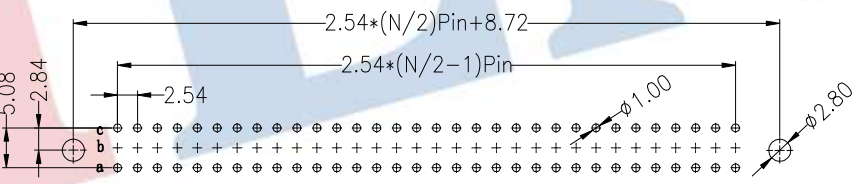
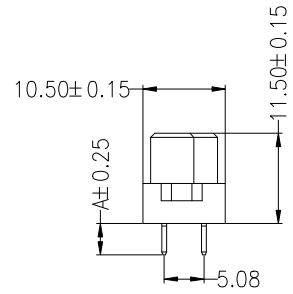
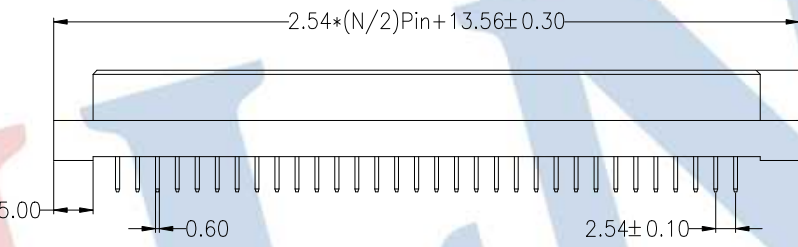

Ordering Information

35113 XX C F S XX X N A X

No. of Pins NPin N=20, 32, 64
 Contact Type F=Female
 Contact Plating G0:Gold Flash S0:Gold Flash/Tin S1:3U" Gold/Tin S2:5U" Gold/Tin S3:10U" Gold/Tin S4:15U" Gold/Tin S5:30U" Gold/Tin
 Contact Material B=Brass P=Phosphor Bronze
 Stream Code

Recommended P.C.B Layout(Top Side)
 (PCB BOARD TOLERANCE±0.05)

Dimension antitheses list	
ITEM	A
Standard	4.00

				OPERATION		DRAW	Jelly Feng	2023.03.29	SCALE	FIT	JILN ® 深圳市锦凌电子有限公司 SHENZHEN JINLING ELECTRONICS CO.,LTD Tel: 86-755-27483253 Fax: 86-755-2997-5588	
				X.X	±0.30				UNIT	mm		
				X.XX	±0.20	CHECK		SIZE	A4	PART NO. 35113XXCFSXXXNAX		
				X.XXX	±0.10		SHEET	1/1				
A0	2023.03.29	NEW DRAWING		Angle	±3°	APPROVE		PROJ.		TITLE: 欧式插座 母座 180度 无鱼叉 缺b排 成品系列图		
REV	DATE	MODIFICATION DESCRIPTION		DIM	TOL							